

POLSON

\$320,000

16,300 sq. ft. Addition

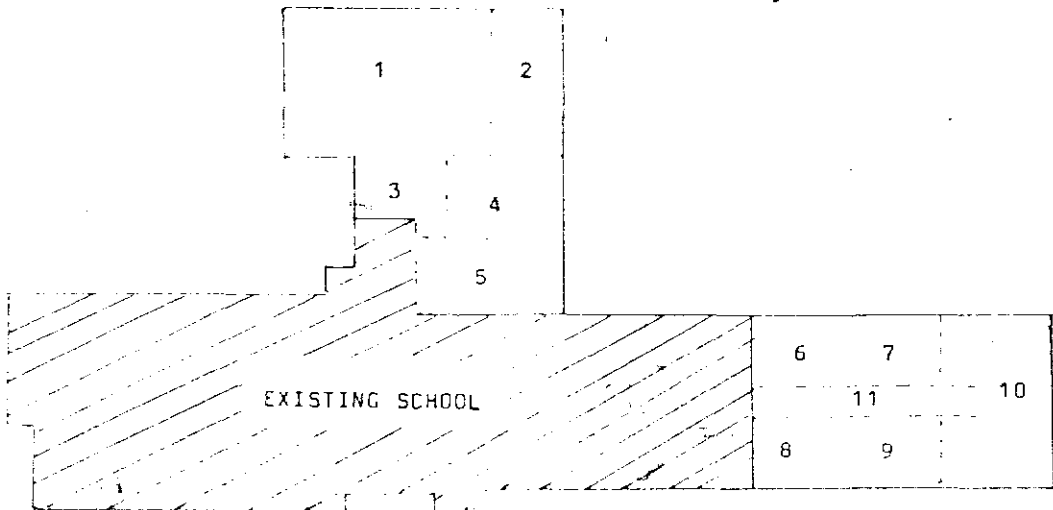

- 1. Gymnasium.
- 2. Auditorium-Multi-purpose room.
- 3. Utility room.

- 4. Teachers room.
- 5. Medical room.
- 6. Class room.
- 7. Class room.

- 8. Class room.
- 9. Class room.
- 10. Kindergarten.
- 11. Corridor.

Polson School Staff Salaries

Polson School was originally called Munroe School and it went by that name from 1953 to June 1960. There was an earlier school called Polson School in existence from 1910 to June 1960. It was located on the south side of Munroe Avenue directly across from the present Polson School on property that is now the parking lot and hall of Holy Eucharist Church.

1953-1954

Agnes Mary Skibinski – Grade 1 – 29 Students - \$1,800.00
Margaret Tanchak – Grade 1 – 30 Students - \$2,010.00
Annie Dorothy Kamrath – Grade 2 – 27 Students - \$2,650.00
Bernice Joan Michalecki – Grade 2 – 26 Students - \$1,800.00
Florence Horrocks – Grade 3 – 33 Students - \$2,650.00
Anna Mima McIntyre – Principal and Grade 4 – 35 Students - \$3,800.00
Total – 180 Students

1954-1955

Agnes Mary Skibinski – Grade 1 – 26 Students - \$2,350.00
Ann Marie Michalison – Grade 1 – 27 Students - \$2,200.00
Annie Dorothy Kamrath – Grade 2 – 29 Students – \$3,200.00
Bernice Joan Michalecki – Grade 2 – 29 Students - \$2,350.00
Florence Horrocks – Grade 3 – 27 Students - \$3,200.00
Anna Mima McIntyre – Principal and Grade 3 – 27 Students - \$3,800.00
Total – 165 Students

1955-1956

Patricia J. Francis – Grade 1 – 29 Students - \$2,200.00
Ann Marie Michalison – Grade 1 – 28 Students – \$2,200.00
Bernice Joan Michalecki – Grade 2 – 25 Students - \$2,350.00
Annie Dorothy Kamrath – Grade 2 – 25 Students - \$3,200.00
Florence Horrocks – Grade 3 – 33 Students – \$3,200.00
Anna Mima McIntyre – Principal and Grade 3 – 28 Students - \$3,800.00
Total – 168 Students

1956-1957

Patricia J. Francis – Grade 1 – 29 Students - \$2,640.00
Ann Marie Michalison – Grade 1 – 26 Students - \$2,840.00
Bernice Jean Michalecki – Grade 2 – 29 Students - \$2,990.00
Annie Dorothy Kamrath – Grade 2 – 30 Students - \$3,625.00
Florence Horrocks – Grade 3 – 31 Students - \$3,705.00
Anna Mima McIntyre – Principal and Grade 3 – 30 Students - \$4,115.00
Total – 175 Students

1957-1958

Ann Marie Michalison – Grade 1 – 31 Students - \$2,840.00
Helen E. Derksen – Grade 1 – 32 Students - \$3,065.00
Annie Dorothy Kammrath – Grade 2 – 31 Students - \$3,625.00
Barbara Stevens – Grade 2 – 29 Students – \$2,500.00
Florence Horrocks – Grade 3 – 30 Students - \$3,705.00
Genevieve Craig – Principal and Grade 3 – 27 Students - \$4,115.00
Total – 180 Students

1958-1959

Helen E. Derksen – Grade 1 – 35 Students - \$3,325.00
Vida McCutcheon – Grade 1 – 35 Students - \$3,540.00
Barbara Stevens – Grade 2 – 25 Students - \$2,500.00
Annie Dorothy Kammrath – Grade 2 – 26 Students - \$3,800.00
Florence Horrocks – Grade 3 – 28 Students - \$3,880.00
Genevieve Craig – Principal and Grade 3 – 25 Students - \$4,290.00
Total – 174 Students

1959-1960

Lorna Anne Mastin – Grade 1 – 27 Students - \$3,000.00
Vida Gorden McCutcheon – Grade 1 – 26 Students - \$4,160.00
Barbara Fern Stevens – Grade 2 – 31 Students - \$3,100.00
Annie Dorothy Kammrath – Grade 2 – 30 Students - \$4,400.00
Florence Horrocks – Grade 3 – 27 Students - \$4,400.00
Genevieve Ann Craig – Principal and Grade 3 – 27 Students - \$5,175.00
Total – 168 Students

1960-1961

Lillian Sawadsky – Grade 1 – 32 Students - \$3,400.00
Vida Gorden McCutcheon – Grade 1 – 33 Students - \$4,450.00
Lois Elizabeth Lundy – Grade 1 – 34 Students - \$3,400.00
Barbara Fern Stevens – Grade 2 – 34 Students - \$3,400.00
Annie Dorothy Kammrath – Grade 2 – 35 Students - \$4,500.00
Winnifred Nellie Williams – Grade 3 – 32 Students - \$4,350.00
Florence Horrocks – Grade 3 – 32 Students - \$4,650.00
Jeanette Marie Brunelle – Grade 4 – 34 Students - \$3,600.00
Gloria Winnifred McPherson – Grade 4 – 33 Students - \$3,900.00
Jeanne Caron – Grade 5 – 27 Students - \$5,050.00
Muriel Solomon – Grade 5 – 27 Students - \$4,350.00
Ethel Catherine Edwards – Grade 5 – 28 Students - \$4,350.00
Mary Teenie Wolfe – Grade 6 – 30 Students - \$4,350.00
Paul Moroz – Vice Principal and Grade 6 – 30 Students – \$5,050.00
Total – 441 Students

1961-1962

Lillian Alice Hoey – Grade 1 – 32 Students - \$4,000.00
Lois Elizabeth Lundy – Grade 1 – 32 Students - \$3,600.00

Lillian Zacharias – Grade 1 – 32 Students - \$3,400.00
Annie Dorothy Kammrath – Grade 2 – 28 Students - \$4,850.00
Alexina Ellen Jorgenson – Grade 2 – 28 Students - \$4,000.00
Barbara Fern Stevens – Grade 2 – 27 Students - \$3,600.00
Florence Horrocks – Grade 3 – 32 Students - \$4,900.00
Winifred Nellie Williams – Grade 3 – 34 Students - \$4,600.00
Jeanette Marie Brunelle – Grade 4 – 33 Students - \$3,600.00
Gloria McPherson – Grade 4 – 32 Students - \$4,100.00
Leonard Douglas Bayko – Grade 5 – 33 Students - \$3,000.00
Ethel Catherine Edwards – Grade 5 – 33 Students - \$4,600.00
Mary Teenie Wolfe – Grade 6 – 32 Students - \$4,350.00
Paul Moroz – Vice Principal and Grade 6 – 33 Students - \$5,450.00
Total – 441 Students

1962-1963

Lillian Alice Hoey – Grade 1 – 35 Students - \$4,000.00
Lois Elizabeth Lundy – Grade 1 – 34 Students - \$3,800.00
Alexina Ellen Jorgenson – Grade 2 – 28 Students - \$4,000.00
Annie Dorothy Jorgenson – Grade 2 – 28 Students - \$4,400.00
Lillian Zacharias – Grade 2 – 28 Students - \$3,600.00
Winifred Nellie Williams – Grade 3 – 24 Students - \$4,600.00
Edith Wiebe – Grade 3 – 23 Students - \$3,000.00
Florence Horrocks – Grade 3 – 23 Students - \$4,900.00
Gloria McPherson – Grade 4 – 26 Students - \$4,300.00
Jeannette Marie Brunelle – Grade 4 – 25 Students - \$3,800.00
Ethel Catherine Edwards – Grade 5 – 29 Students – \$4,600.00
Henry Krickhan – Grade 5 – 28 Students - \$3,700.00
John Petrash – Grade 6 – 35 Students - \$4,900.00
Mary Teenie Wolfe – Grade 6 – 34 Students - \$4,350.00
Total – 377 Students

1963-1964

Edith Sophia Bethel – Grade 1 – 28 Students - \$4,650.00
Lillian Alice Hoey – Grade 1 – 29 Students – \$4,200.00
Winnifred Erma Warnick – Grade 1 – 26 Students - \$4,350.00
Alexina Ellen Jorgenson – Grade 2 – 29 Students - \$4,000.00
Annie Dorothy Kammrath – Grade 2 – 30 Students - \$4,950.00
Morna-June Cecile Morrow – Grade 3 – 32 Students - \$3,100.00
Edith Roberts – Grade 3 – 26 Students - \$3,400.00
Edith Wiebe – Grade 3 – 32 Students - \$3,100.00
Gloria Winifred Mollard – Grade 4 – 32 Students - \$4,500.00
Lorraine Bourrier – Grade 4 – 31 Students - \$3,400.00
Ethel Catherine Edwards – Grade 5 – 34 Students - \$4,600.00
George Ronald Hinthier – Grade 5 – 34 Students - \$3,200.00
Mary Teenie Wolfe – Grade 6 – 31 Students - \$4,350.00
Arthur Ben Funk – Grade 6 – 29 Students - \$4,500.00

Total – 423 Students

1964-1965

Edith Sophia Bethel – Grade 1 – 25 Students - \$4,850.00
Maureen Lynne Dressel – Grade 1 – 32 Students - \$3,000.00
Lillian Alice Hoey – Grade 1 – 30 Students - \$4,550.00
Alexina Ellen Jorgenson – Grade 2 – 31 Students - \$4,440.00
Annie Dorothy Kammrath – Grade 2 – 32 Students - \$5,150.00
Edith Wiebe – Grade 3 – 32 Students - \$3,500.00
Morna-June Cecile Morrow – Grade 3 – 32 Students - \$3,100.00
Marlene Rebecca Tinling – Grade 4 – 31 Students - \$4,000.00
Gloria Winifred Mollard – Grade 4 – 31 Students - \$4,700.00
Edith Roberts – Grade 4 – 24 Students - \$3,400.00
George Ronald Hinthner – Grade 5 – 30 Students - \$3,300.00
Ethel Catherine Edwards – Grade 5 – 30 Students - \$4,800.00
Arthur Ben Funk – Grade 6 – 32 Students - \$4,500.00
Mary Teenie Wolfe – Grade 6 – 31 Students - \$4,550.00
Total – 423 Students

1965-1966

Jessie Violet McDonald – Special Education – 12 Students - \$3,850.00
Maureen Lynne Dressel – Grade 1 – 29 Students - \$3,000.00
Lillian Alice Hoey – Grade 1 – 30 Students - \$4,550.00
Edith Sophia Bethel – Grade 1 – 29 Students - \$4,900.00
Alexina Ellen Jorgenson – Grade 2 – 27 Students - \$4,650.00
Annie Dorothy Kammrath – Grade 2 – 28 Students - \$5,150.00
Leslie Irene Kolisnyk – Grade 3 – 34 Students - \$3,000.00
Edith Wiebe – Grade 3 – 34 Students - \$3,700.00
Linda Irene Scharein – Grade 4 – 29 Students - \$3,000.00
Gloria Winnifred Mollard – Grade 4 – 30 Students - \$4,700.00
Edith Roberts – Grade 5 – 29 Students - \$3,600.00
Carol Jean Anderson – Grade 5 – 29 Students - \$4,300.00
James Edward Johnson – Grade 6 – 33 Students - \$3,000.00
Paul Moroz – Vice Principal and Grade 6 – 33 Students - \$8,300.00
Total – 406 Students

1966-1967

Jessie McDonald – Special Education – 17 Students - \$4,400.00
Judy Bugera – Grade 1 – 21 Students - \$3,300.00
Edith Bethel – Grade 1 – 31 Students - \$5,250.00
Lillian Hoey – Grade 1 – 30 Students - \$4,900.00
Alexina Jorgenson – Grade 2 – 29 Students - \$5,050.00
Annie Kammrath – Grade 2 – 29 Students - \$5,500.00
Leslie Kolisnyk – Grade 3 – 28 Students - \$3,300.00
Kathie Ewert – Grade 3 – 24 Students - \$3,300.00
Marilyn Mushkat – Grade 4 – 34 Students - \$3,300.00

Linda Scharein – Grade 4 – 32 Students - \$3,300.00
Carol Anderson – Grade 5 – 28 Students - \$4,600.00
Gwenn McDonald – Grade 5 – 29 Students - \$3,300.00
James Johnson – Grade 6 – 33 Students - \$3,300.00
Paul Moroz – Vice Principal and Grade 6 – 30 Students - \$9,300.00
Total – 395 Students

1971-1972

Mr. Robert McElroy – Principal - \$10,340.00
Mrs. E. A. Browaty - \$6,820.00
Mrs. J. D. Diakiw - \$7,510.00
Mrs. C. I. A. Facia - \$6,960.00
Mrs. P. A. Hilder - \$7,820.00
Mrs. I. M. Kazina - \$6,785.00
Mr. E. Koenig - \$9,230.00
Mrs. C. A. Lacroix - \$6,785.00
Miss M. R. Laurie - \$8,030.00
Mr. R. J. Mason - \$6,380.00
Miss J. V. McDonald - \$7,735.00
Mrs. N. E. Nelson – \$6,010.00
Mrs. H. M. Novakowski - \$6,710.00
Mrs. L. T. Oandasan - \$9,100.00
Miss M. L. Price - \$5,560.00
Mrs. B. L. Simmons - \$9,210.00
Mrs. S. J. Storjord - \$6,710.00
Mrs. S. M. Barnes – \$7,815.00
Custodian - \$6,728.00
Custodian Aide - \$2,160.00
Clerk IV - \$5,520.00
Clerk III - \$4,200.00
Clerk II - \$3,885.00
Clerk I - \$3,263.00
Library Clerk - \$3,570.00
Library Technician - \$4,420.00
Paraprofessional - \$2,870.00