

By ARN McEWEN

SCHOOL IN THE NEWLY DEVELOPED AREA

Last April building plans were approved by the East Kildonan School Board, submitted and approved by the Department of Education, and we understood from Architects Smith, Carter & Katelnikoff that work would proceed immediately. Since that time, however, there have been a number of delays in purchasing the site from various owners and having their buildings moved off the property.

The new 8-room elementary school is located on Golspie st. between Oakview and Hazeldell, in an area approximately $1\frac{1}{2}$ blocks square. Excavation started June 16th and work is now underway on the sub-structure.

A name for the new school had been discussed last year, if and when it was built. The name is now official, chosen to commemorate a pioneering and influential man, one who had done so much for the early life of this community — Mr. Neil Campbell.

The Board recently accepted \$6,400 from the Land Development Company to purchase furniture to equip the Neil Campbell School. Tenders for the equipment will be received by the secretary prior to our August meeting.

* * *

June 23 19

Boardroom

By ARN McEWEN

SCHOOL IN THE NEWLY DEVELOPED AREA

Last April building plans were approved by the East Kildonan School Board, submitted and approved by the Department of Education, and we understood from Architects Smith, Carter & Katelnikoff that work would proceed immediately. Since that time, however, there have been a number of delays in purchasing the site from various owners and having their buildings moved off the property.

The new 8-room elementary school is located on Golsple st. between Oakview and Haseldell, in an area approximately 1½ blocks square. Excavation started June 16th and work is now underway on the sub-structure.

A name for the new school had been discussed last year, if and when it was built. The name is now official, chosen to commemorate a pioneering and influential man, one who had done so much for the early life of this community — Mr. Neil Campbell.

The Board recently accepted \$6,400 from the Land Development Company to purchase furniture to equip the Neil Campbell School. Tenders for the equipment will be received by the secretary prior to our August meeting.

* * *

on
be
dr
st
M
fir
m
fe
de

to
do
de
m
st
an

tic
10
M
ve
pr

F
C

Neil Campbell School 1956 - 1957

Built in 1956 at a cost of \$130,000.00

Opened on Monday November 19, 1956

Eight Rooms, containing grades 1-6 with a total of 246 students

Neil Campbell School Principal Marion Anderson's salary in 1956-1957 was \$4,265.00 per year; she was also the Grade Six teacher.

Original Neil Campbell Teachers in 1956-1957

Kathryn Harper, Grade One, 24 students, her salary was \$2,100.00 per year and the class began the year at Prince Edward School.

Elizabeth Loeffler, Grade One, 30 students, her salary was \$2,740.00 per year and the class began the year at Lord Wolseley School.

Nancy Wells, Grade Two, 32 students, her salary was \$2,440.00 per year and the class began the year at Prince Edward School.

Ada Allen, Grade Two, 33 students, her salary was \$3,725.00 per year and the class began the year at Prince Edward School.

Marion Schick, Grade Three, 35 students, her salary was \$2,820.00 per year and the class began the year at Lord Wolseley School.

Blanche Erickson, Grade Four, 24 students, her salary was \$2,440.00 per year and the class began the year at Lord Wolseley School.

Laura Asselstine, Grade Five, 37 students, her salary was \$3,665.00 per year and the class began the year at Prince Edward School.

Marion Anderson, Grade Six Teacher as well as Neil Campbell's Principal, 31 students, her salary for doing both jobs was \$4,265.00 per year and the class began at Lord Wolseley School

Four Classes began the school year with their teachers at Lord Wolseley School and moved to Neil Campbell on November 19, 1956. Four classes of students began the school year at Prince Edward School with their teachers and moved to Neil Campbell on November 19 as well. Due to overcrowding at both Lord Wolseley and Prince Edward, there were staggered hours in effect at these 2 schools until Neil Campbell opened. Lord Wolseley had more than 750 students prior to November 19 and Prince Edward in excess of 700 students.

The original catchment area was the 500 and 600 blocks from Neil Avenue north to the Rossmere Golf and Country Club. Students in Grades 1-4 living in the 400 block of Hazel dell, Linden, Greene and Roberta went to Lord Wolseley School for the entire school year. Grade 1-4 students living in the 400 block of Oakview, Dunrobin, Helmsdale and Melrose (Kimberly) went to Miles Mac for the entire school year. All grade 5 and 6 students living in the 400, 500 and 600 blocks from Neil Avenue north to Chelsea Avenue went to Neil Campbell School. All grade 5 and 6 students living in the 400, 500 and 600 blocks from Melrose (Kimberly) to Roberta went to Lord Wolseley School.

New School Open Monday

East Kildonan's newest school, the Neil Campbell, will be opened Monday morning.

The elementary school will accommodate six classes from Lord Wolseley and two from Prince Edward which have been staggered since the fall term commenced.

Situated at Golspie and Oakview, the school will accommodate grades 1-6 pupils in the 400 and 500 blocks from Nell ave. north.

Miss M. Anderson will be the principal.

Later in the week an official opening will be held when parents will have an opportunity to visit the school.



Mayor Suttie of East Kildonan is seen here handing over the keys of the new Neil Campbell School to L. A. McMahon, chairman of the East Kildonan School Board, at the official opening of the school last Friday night. Members of the Municipal Council and School Board, together with a number of interested citizens, attended. Mr. Justice A. M. Campbell, after whose father the school has been named, was present and took part in the ceremonies. He stated that he appreciated the thoughtfulness of the School Board in perpetuating the memory of the name of his father, and complimented the Board on its appreciation of local history. The school was constructed by the British American Land Development Co. Ltd. under its contract with the municipality.

Neil Campbell School The First Ten Years 1956-1966

The first ten years of Neil Campbell's existence was a period of rapid change and growth in East Kildonan. The population of East Kildonan grew by 10,000 in the ten years from 1956 to 1966 an almost 60% increase in the decade but in the same period the school age population grew by almost 100%. This rapid growth affected all of the schools in East Kildonan including Neil Campbell. To handle the rapidly increasing school population new schools were built in this decade; Sherwood School in 1957, Munroe Junior High in 1958, McLeod School in 1959, Morse Place Junior High in 1959, Hampstead School in 1960 and John Henderson Junior High in 1962. As well there were additions to these and the other schools in East Kildonan.

The East Kildonan School District found it necessary to shuffle the school boundaries on a yearly basis and move students from school to school in order to contain this great population explosion and Neil Campbell was not immune from these changes. In the 1956-1957 school year Neil Campbell had two classes of grade one students, two classes of grade two students and one class each of grade three, four, five and six. The next year, there was the same distribution of grades but in the following year 1958-1959 this changed in a dramatic fashion. Neil Campbell became a school for just four grades; three classes of grade ones, two classes of grade two, one class of grade three students, one class of a combined grade three and four students and one class of grade four students.

After the first addition to the school in the 1959-1960, the grade five and six students returned but because of the shortage of space for junior high students, Neil Campbell became home for the first and last time to grades seven, eight and nine students. Thus for this year, there were two classes of grade one, , four classes of grade two, two classes of grade three, two classes of grade four, two classes of grade five, one class of grade six, three classes of grade seven, one class of grade seven and eight students and one class of grade eight and nine students.

The following year 1960-1961 saw the school move back to just the elementary grades; three classes of grade one students, one class of grade one and two students, three classes of grade two students, three classes of grade three students and two classes each of grades four, five and six students. The final year for this combined grade class occurred in the 1963-1964 school year. The following year 1961-1962 saw the second last year of the two grade classes with a combined grade two and three classroom in existence. This year saw a class of ungraded slow learners as they were called then but we would refer to them now as special education students now. This group had the misfortune of being shuffled from school to school in East Kildonan space permitting until they finally found a permanent home at Polson School though they did return for one final year during the 1964-1965 school year. By the 1965-1966 school year Neil Campbell settled down to a pattern of three classes for each grade with one grade having one extra class.

The year 1957 saw the formation of the first parent involvement in the school with the creation of the Neil Campbell Home and School Association on November 7 with the

first officers being President Robert Sinclair, Vice President Mary Drake, Secretary Frances Beard, a teacher at the school and Treasurer Grace McMillan. This association was in existence until June 1965 when it was dissolved by Principal Charles E. Douglas.

The year 1959 saw two big changes to Neil Campbell first was the departure of Neil Campbell's first principal Marion Anderson and the coming of Charles Douglas as the new principal, he was to remain in this position for the next 29 years. Mr. Douglas had been the vice principal of Miles MacDonell Collegiate, when he left Neil Campbell in 1988 he returned to Miles Mac as its principal.

The second big change was the two storey addition on the north side of the school; this \$195,000 addition added the gym and twelve additional classrooms. The original eight room school had cost \$130,000 including the cost of the land and furnishing the school. With this addition Neil Campbell became a larger school jumping from 243 students in 1958-1959 to 528 students in 1959-1960. As result of this Neil Campbell obtained its first vice principal George Wall who later became a superintendent in the River East School Division. It was at Neil Campbell that Mr. Wall met and later married Miss Joan Milan a grade one teacher at Neil Campbell. The school continued to have a vice principal on its staff until the early 2000's.

The early and middle 1960's saw students involved in many of the activities that later became familiar to later students. There was the start of jam pail curling, interschool soccer, baseball, the annual field day and of course the music festival. The grade six patrols had become an important part of the school and ensured the safety of the students.

As the years passed staff arrived and left; George Wall left as vice principal in June 1962, he was replaced as vice principal and grade six teacher by Orest Lazaruk who remained until June 1967. Original Neil Campbell teacher Ada Allen left in June 1966 leaving Kathryn Harper as the last original teacher still teaching at Neil Campbell when the 1966-1967 school year began.

Neil Campbell School 1956-1957 To 1966-1967

Teacher	Grade	Number of Students	Salary
1956-1957			
Kathryn Harper	1	24	\$2,100.00
Elizabeth Loeffler	1	30	\$2,740.00
Nancy Wells	2	32	\$2,440.00
Ada Allen	2	33	\$3,625.00
Marion Schick	3	35	\$2,820.00
Blanche Erickson	4	24	\$2,440.00
Laura Asselstine	5	37	\$3,665.00
Marion Anderson (Principal)	6	31	\$4,265.00
1957-1958			
Kathryn Harper	1	34	\$2,800.00
Frances Beard	1	32	\$2,500.00
Nancy Wells	2	28	\$2,500.00
Ada Allen	2	31	\$3,665.00
Marion Schick	3	31	\$2,900.00
Blanche Erickson	4	39	\$2,500.00
Laura Asselstine	5	40	\$3,665.00
Marion Anderson (Principal)	6	39	\$4,265.00
1958-1959			
Joan Milan	1	29	\$2,500.00
Kathryn Harper	1	28	\$3,060.00
Frances Beard	1	29	\$2,500.00
Ada Allen	2	33	\$3,840.00
Vera Stobbe	2	33	\$2,600.00
Jean Tatlock	3	29	\$3,000.00
Laura Asselstine	3 and 4	29	\$3,665.00
Marion Anderson (Principal)	4	33	\$4,530.00
1959-1960			
Joan Milan	1	33	\$3,000.00
Kathryn Harper	1	32	\$3,660.00
Ada Allen	2	32	\$4,400.00
Vera Stobbe	2	32	\$3,200.00

Roseanne Pryden	2	32	\$3,000.00
Frances Beard	2	32	\$3,100.00
Rosaline Cameron	3	31	\$3,800.00
Elaine McCullough	3	30	\$3,600.00
Helen Dyryk	4	24	\$3,300.00
Margery Smith	4	26	\$3,600.00
Keith McComb	5	27	\$3,000.00
Leona Philippot	5	28	\$4,300.00
George Wall (Vice Principal)	6	36	\$4,060.00
Joan Brisley	7	28	\$4,400.00
Alice Wiley	7	29	\$6,050.00
William Staska	7	29	\$4,600.00
Jacob Friesen	7 and 8	29	\$6,400.00
Dorothy Ryan	8 and 9	16	\$6,400.00

1960-1961

Joan Milan	1	31	\$3,200.00
Kathryn Harper	1	31	\$4,250.00
Frances Beard	1	28	\$3,400.00
Laura Asselstine	1 and 2	18	\$4,500.00
Roseanne Pryden	2	32	\$3,000.00
Vera Stobbe	2	33	\$3,400.00
Ada Allen	2	28	\$4,500.00
Rosaline Cameron	3	32	\$4,000.00
Ellen May	3	34	\$3,600.00
Atsumi Odaguchi	3	32	\$3,300.00
Margery Smith	4	33	\$3,650.00
Margaret Thiessen	4	33	\$3,200.00
Leonie Philippot	5	30	\$4,350.00
Keith McComb	5	28	\$3,200.00
Hubert Jonasson	6	32	\$3,200.00
George Wall (Vice Principal)	6	29	\$4,300.00

1961-1962

Frances Beard	1	27	\$3,600.00
Elaine Doucette	1	24	\$3,800.00
Kathryn Harper	1	26	\$4,400.00
Alfreda Sime	1	24	\$3,500.00
Evelyn MacKinlay	(ungraded)	22	\$4,850.00
Vera Dueck	2	30	\$3,700.00

Ada Allen	2	31	\$4,750.00
Laura Asselstine	2	26	\$4,750.00
Dorothy Scarth	2 and 3	24	\$4,350.00
Rosaline Cameron	3	28	\$4,200.00
Helen Derksen	3	34	\$4,350.00
Atsumi Odaguchi	3	35	\$3,300.00
Phyllis Budyk	4	35	\$4,350.00
Margery Smith	4	35	\$3,900.00
Edward Steel	4	35	\$3,600.00
John Heppner	5	35	\$3,000.00
Leonie Philippot	5	35	\$4,500.00
Hubert Jonasson	6	31	\$3,500.00
George Wall (Vice Principal)	6	32	\$4,500.00

1962-1963

Frances Beard	1	29	\$3,800.00
Elaine Doucette	1	30	\$3,800.00
Kathryn Harper	1	30	\$4,400.00
Alfreda Irvine	1	30	\$3,000.00
Laura Asselstine	2	27	\$4,750.00
Vera Dueck	2	33	\$3,900.00
Ada Allen	2	36	\$4,750.00
Florence Figgures	3	26	\$4,350.00
Atsumi Odaguchi	3	34	\$3,500.00
Sandra McGregor	3	32	\$3,100.00
MaryAnn Young	4	34	\$3,000.00
Edward Steel	4	37	\$3,800.00
Elizabeth Irwin	4	36	\$4,500.00
Leonia Philippot	5	35	\$4,500.00
Norman Grywinski	5	35	\$3,200.00
Esther Heppner	5	35	\$3,400.00
Henry Fast	6	32	\$3,200.00
Orest Lazaruk (Vice Principal)	6	35	\$4,900.00

1963-1964

Elaine Doucette	1	33	\$4,050.00
Kathryn Harper	1	33	\$4,400.00
Sheila Kilpatrick	1	32	\$4,350.00
Ada Allen	2	27	\$4,800.00
Frances Beard	2	27	\$4,000.00

Marina Dick	2	27	\$3,300.00
Margaret Heidebrecht	2	28	\$3,000.00
Sandra McGregor	2 and 3	27	\$3,300.00
Florence Figgures	3	33	\$4,350.00
Atsumi Odaguchi	3	32	\$4,000.00
Elizabeth Irwin	4	26	\$4,500.00
Edward Steel	4	34	\$4,000.00
MaryAnn Young	4	34	\$3,000.00
Norman Grywinski	5	24	\$3,200.00
Esther Heppner	5	35	\$3,400.00
Claire Maillard	5	32	\$3,200.00
Henry Fast	6	30	\$3,200.00
Orest Lazaruk (Vice Principal)	6	32	\$5,300.00

1964-1965

Evelyn MacKinlay	(ungraded)	12	\$5,050.00
Elaine Doucette	1	32	\$4,250.00
Kathryn Harper	1	31	\$4,600.00
Shelia Kilpatrick	1	31	\$4,350.00
Ada Allen	2	31	\$5,000.00
Frances Beard	2	31	\$4,200.00
Marina Dick	2	31	\$3,300.00
Sandra Grevstad	3	34	\$3,500.00
Sandra Unruh	3	29	\$3,200.00
Florence Figgures	3	34	\$4,550.00
Edward Steel	4	27	\$4,200.00
Kathryn Wilkinson	4	27	\$3,000.00
Elizabeth Irwin	4	27	\$4,700.00
Atsumi Odaguchi	5	33	\$5,100.00
Dorothy Scarth	5	33	\$4,550.00
Claire Maillard	5	32	\$3,200.00
Henry Fast	6	33	\$3,700.00
Janice Goodall	6	31	\$4,200.00
Orest Lazaruk (Vice Principal)	6	32	\$6,000.00

1965-1966

Sheila Kilpatrick	1	28	\$4,550.00
Dorothy Kroeker	1	28	\$3,900.00
Kathryn Harper	1	29	\$4,600.00
Shirley Churchill	1	28	\$4,200.00

Frances Beard	2	30	\$4,350.00
Joan Wilkinson	2	30	\$3,000.00
Ada Allen	2	30	\$5,000.00
Florence Figgures	3	31	\$4,550.00
MaryLou Moore	3	28	\$3,000.00
Sandra Grevstad	3	30	\$3,700.00
Elizabeth Irwin	4	35	\$4,700.00
Edward Steel	4	34	\$4,350.00
Kathryn Wilkinson	4	34	\$3,200.00
Dorothy Scarth	5	34	\$4,550.00
Claire Maillard	5	34	\$3,400.00
Kristjan Arnason	5	22	\$4,000.00
Elaine Doucette	6	31	\$4,450.00
Henry Fast	6	32	\$3,900.00
Orest Lazaruk (Vice Principal)	6	31	\$6,000.00

1966-1967

Shelia Kilpatrick	1	29	\$4,900.00
Kathryn Harper	1	29	\$4,950.00
Shirley Churchill	1	28	\$4,500.00
Lynn Roos	2	22	\$3,300.00
Lynda Sotham	2	31	\$3,300.00
Joan Wilkinson	2	33	\$3,300.00
Frances Beard	2	32	\$4,900.00
MaryLou Moore	3	30	\$3,300.00
Helen Derksen	3	24	\$4,900.00
Sandra Grevstad	3	31	\$4,300.00
Kathryn Wilkinson	4	24	\$3,700.00
Edward Steel	4	32	\$4,900.00
Elizabeth Irwin	4	33	\$5,500.00
Claire Taillefer	5	29	\$3,900.00
David Spiers	5	35	\$3,300.00
Dorothy Scarth	5	35	\$4,950.00
Elaine Doucette	6	17	\$5,000.00
Kristjan Arnason	6	30	\$4,300.00
Orest Lazaruk (Vice Principal)	6	33	\$8,700.00

Neil Campbell Salaries 1971-1972

Mr. C. E. Douglas – Principal - \$16,520.00
Mr. A. H. Enns – Vice Principal - \$12,880.00
Mrs. F. Beard - \$6,860.00
Miss S. A. Brewer - \$7,870.00
Mrs. M. R. Brown - \$7,300.00
Miss S. S. Churchill - \$7,980.00
Mrs. F. H. Figures - \$6,710.00
Mrs. K. W. Harper – \$6,710.00
Mrs. E. M. Irwin - \$7,880.00
Mr. J. H. Kautz - \$6,180.00
Mrs. S. J. Kilpatrick - \$6,710.00
Miss M. G. Kozak - \$8,070.00
Mrs. K. L. Kroeker – \$5,660.00
Mr. R. E. McQuarrie - \$5,870.00
Mrs. Y. E. Oliphant – \$6,710.00
Mrs. H. Rempel - \$5,650.00
Mr. R. A. Seamark - \$6,500.00
Mrs. C. M. Smith - \$6,710.00
Mr. E. R. Steel - \$6,710.00
Mrs. C. D. Urchenko - \$5,870.00
Mrs. T. E. Walsh - \$5,330.00
Mrs. R. Cameron - \$8,480.00
Mrs. C. L. Villebrun - \$7,535.00
Custodian - \$6,728.00
Custodian Aide - \$2,160.00
Mrs. S. Stacey Clerk II - \$3,885.00
Library Technician - \$4,441.00
Paraprofessional - \$2,757.00

NEIL CAMPBELL

\$205,000

10,500 sq. ft. Addition

POL

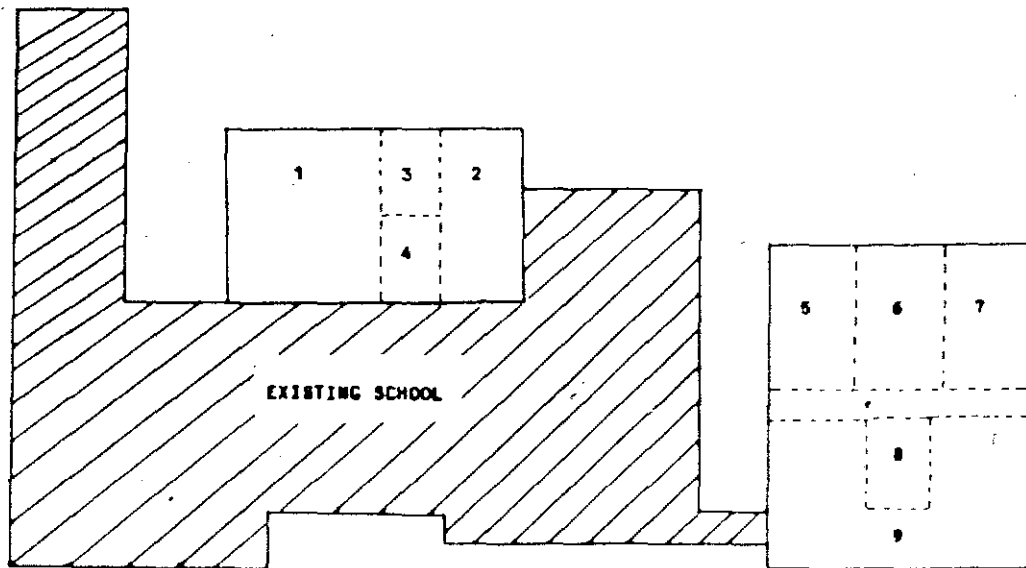

1. Material Resource Centre.
2. Auditorium-Multi-purpose room.

3. Audio workshop.
4. Storage room.
5. Class room.
6. Class room.

7. Class room
8. Wash rooms.
9. Kindergarten.

SAL

Unexpected holiday

March 28 1978

Watermain break floods school

The students of Neil Campbell School got an unexpected holiday last week, when a watermain break flooded the school's basement with 13 feet of water.

The break knocked out the school's electrical systems and heating and the school was closed for last Tuesday and Wednesday.

A caretaker discovered the break at 7:30 Tuesday morning, when he found the

school basement full of water. As well, there was up to a foot in some of the main floor rooms of the school.

J. MacDonald, director of maintenance for the division, said a saddle type joint between the City's 12 inch water line and the one and a half inch line feeding the north end of the school wore out and had been leaking for some time before being forced into the basement.

He said an estimated 200,000 gallons of water filled the basement, with clean-up and damage costs estimated at \$10,000.

The City Fire Department pumped the water out of the school, and did most of the clean-up work.

The majority of the clean-up was done by Wednesday, and students returned to the school Thursday.

Neil Campbell School History

By Jim Smith – Neil Campbell Student from 1966-1972

The creation of Neil Campbell School can be traced to an agreement signed between the then Municipality of East Kildonan and the BACM [a land development company] in April 1954. The agreement gave the company all of the municipally owned land in the area between from Neil Avenue north to Leighton Avenue from Roch to Raleigh. The company was given the right to develop the area for residential, commercial and industrial development. The company was to provide all of the local improvements required such as sewer and water, street paving, paved sidewalks and streetlights.

As this area prior to this development was lightly dotted with homes, no elementary school existed in this district; students living in the present Neil Campbell School area went to school at either Lord Wolseley School or Prince Edward School. The development company as part of its agreement was required to build at its own expense a new eight room elementary school costing approximately \$130,000.00 and then turn it over to the East Kildonan School District. The first location that was looked at for this new school was the east side of Watt Street between Hazel Dell Avenue and Oakview Avenue but the decision was soon made to move the location one block to the east on Golspie.

The building of the new homes in the immediate catchment area of Neil Campbell School began in 1955 in the 400 blocks of Kimberly, Helmsdale, Dunrobin, Oakview, Linden, Greene and Roberta. Home construction in the 500 blocks began in 1956, the construction of new homes in the 600 blocks were in 1957, 1958 and 1959.

Prior to 1955 there had been a small number of homes on these streets, but as well there were homes on the south side of the 600 block of Oakview to the power lines as well as one house in the 600 block of Hazel Dell. These two 600 blocks were eliminated when Neil Campbell School was built. Some of the old homes in the 400, 500 blocks and 600 blocks that still exist today date to the early 1920's when Oakview Avenue east of Henderson Highway was called Hawarden Avenue and Hazel Dell Avenue east of Henderson Highway was called Donegal Avenue. These streets were changed to their present names in the late 1920's. Most of what is now the school grounds was used as a grazing area for a small number of cattle.

The clearing of the land needed for Neil Campbell and the removal of some of the old buildings began in the spring of 1956 with construction beginning in late May. It was first hoped that the school would be ready for September 1956 but this plan was soon found to be impracticable.

The first students of Neil Campbell began the school year 1956-1957 in either Lord Wolseley School, four classes or Prince Edward School, four classes. These students started the school year with the same teacher and same classmates that they would be

with at Neil Campbell. On Friday November 16, 1956, these original 246 students of Neil Campbell School along with their 8 teachers spent their last day at their old school and on Monday November 19, 1956 they moved into the new eight room Neil Campbell School.

The Neil Campbell of 1956 consisted of just the middle section of the present building. The gym and the 2 storey section were added in 1959. The library, the multipurpose room and the southern end were added in the 1968-1969 school year just in time for the introduction of kindergarten in September 1969. The present hallway to the library was originally the office area and the present office space was a classroom prior to the 1968-1969 addition.

The original staff of Neil Campbell School consisted of Principal Marion Anderson who also was the teacher for 31 grade six students; her total salary was \$4,265.00 for the year. This class started the year at Lord Wolseley School. Marion Anderson remained at Neil Campbell until June 1959 when Charles E. Douglas took over, he was to remain as principal until June 1988.

Kathryn Harper taught 24 grade one student at a salary of \$2,100.00 and the class began at Prince Edward School. Elizabeth Loeffler taught 30 grade one students, her salary was \$2,740.00 and her class began the year at Lord Wolseley Nancy Wells was the teacher for 32 grade two students, she made \$2,440.00 for the year and her class began at Prince Edward. Ada Allen also taught grade two, her class consisted of 33 students, she made \$3,725.00 and the class came from Prince Edward. Marion Schick taught a class of 35 grade three students at a salary of \$2,820.00, her class started at Lord Wolseley. Blanche Erickson taught the grade four students, 24 students in all at a salary of \$2,440.00, her class began at Lord Wolseley. Laura Asselstine taught 37 grade five students at a salary of \$3,665.00, the class began at Prince Edward School.

The first ten years of Neil Campbell's existence was a period of rapid change and growth in East Kildonan. The population of East Kildonan grew by 10,000 in the ten years an almost 60% increase in the decade but in the same period the school age population by almost 100%. This rapid growth affected all of the schools in East Kildonan including Neil Campbell. To handle the rapidly increasing school population new schools were built in East Kildonan; Sherwood School in 1957; Munroe Junior High in 1958, McLeod School in 1959; Morse Place Junior High in 1959, Hampstead School in 1960 and John Henderson Junior High in 1962 replacing the Melrose Junior High building which became the north wing of Miles MacDonell Collegiate.

The original catchment area of Neil Campbell was the 500 and 600 blocks from Neil Avenue north to the Rossmere Golf and Country Club. Students in grades 1-4 living in the 400 blocks of Hazel Dell, Linden, Greene and Roberta went to Lord Wolseley School for the entire year of 1956-1957. Grade 1-4 students living in the 400 blocks of Oakview, Dunrobin, Helmsdale and Melrose (Kimberly) went to classrooms in Miles MacDonell Collegiate for that first year as well. All grade 5 and 6 students living in the 400, 500 and 600 blocks from Neil Avenue north to Chelsea Avenue went to Neil Campbell. All grade

5 and 6 students living in the 400, 500 and 600 blocks from Melrose (Kimberly) north to Roberta Avenue went to Lord Wolseley School.

The East Kildonan School District found it necessary to shuffle the school boundaries on a yearly basis in the 1950's and early 1960's and Neil Campbell School was affected probably more than any other school in the area. The 1957-1958 school year saw the same distribution of grades as the first year, two classes of grade one, two classes of grade two and one class each of grade three, four, five and six.

The first parents group was formed on November 7, 1957; this was called the Neil Campbell Home and School Association with the first officers being President Robert Sinclair, Vice President Mary Drake and Secretary Frances Beard. This first organization was in existence until June 1965 when it was dissolved by Principal Charles E. Douglas.

In the following year 1958-1959, Neil Campbell School became a school for just four grades, three classes of grade one, two classes of grade two, one class of grade three students, one class of combined grade three and four students and one class of grade four students.

The school year 1959-1960 saw the first addition to the school with the construction of an auditorium/gym and a two storey section consisting of twelve new classrooms at a cost of \$195,000.00. The grade five and six students returned and for the first and only year junior high students from the northern part of East Kildonan attended Neil Campbell due to a shortage of space for grade seven, eight and nine students in the junior high schools. For this year there were two classes of grade one students, four classes of grade two, two classes of grade three, two classes of grade four, two classes of grade five, one class of grade six, three classes of grade seven, one class of grade seven and eight students and one class of grade eight and nine students.

The addition to the school meant the total student enrolment jump from 243 students to 528 students. This large jump in the number of students enabled Neil Campbell to have its first vice principal Mr. George Wall who later became the superintendent in the River East School Division in the 1990's. Mr. Wall met and later married a grade one teacher at Neil Campbell Miss Joan Milan a grade one teacher. Their relationship was kept a secret from other members of the staff until the couple decided to marry. The school continued to have a vice principal until the early 2000's.

The following year 1960-1961 saw the school revert to just the elementary grades with three classes of grade one students, one class of grade one and grade two students, three classes of grade two students, three classes of grade three students and two classes each of grade four, five and six students. The following year saw a combined grade two and grade three class. This year a class of ungraded slow learners shared Neil Campbell with the regular students. This group of moderately mentally challenged students moved from school to school in the area as space was found for them. This group returned to Neil Campbell for the last time in the 1964-1965 school year.

The school year 1963-1964 saw the Neil Campbell in its last year having two grades in one classroom with a combined grade two and three class. After this year Neil Campbell settled down into a general pattern of having three classes for each grade with one grade usually having an extra class. This pattern was to continue for the next ten years or so until declining numbers reduced the number of classes to two classes per grade. The number of students in each classroom from 1956 till the mid 1970's ranged from a high of 37 students to a low of 17 students in the regular school program. In the first few years of Neil Campbell's history the average was about 33 students per class dropping to about 30 students per classroom by the late 1960's. The two years of slow learners at Neil Campbell had 22 students in 1961-1962 and 12 students in the 1964-1965 school year.

The early and middle 1960's saw students involved in many of the activities that were to continue into later years, jam pail curling, interschool soccer and baseball, the annual school field day and of course the annual music festival. The grade six patrols became an important part of the school and ensured the safety of the students. The patrol program was supplemented by the city wide Elmer the Safety Elephant program which began in 1963 at Neil Campbell and continued in existence until the early 1970's which provided students a reminder to think safety and look both ways when crossing the street.

June 1966 saw the departure of Ada Allen one of Neil Campbell's original teachers from the school. As of 2007 she is the last original staff member of Neil Campbell still alive. Her departure left Kathryn Harper as the last original staff member teaching at Neil Campbell a position she held until her retirement in the mid 1970's.

September 1966 saw a grade one student enter Neil Campbell who was later to gain fame with his father and entry in the Guinness Book of World Records for the longest journey by canoe in his journey to the Amazon. Dana Starkell went to Neil Campbell until his graduation from grade six in June 1972.

Canada's Centennial Year of 1967 brought many special events and activities to Canadians everywhere and this included some special activities for Neil Campbell students. In the spring of 1967 each classroom of grade two to grade six students planted a tree on the south side of the playground to celebrate Canada's Centennial. Unfortunately none of these trees lasted more than a few years as they were all torn out or trampled on by individuals who did not appreciate their significance. All Neil Campbell students participated in a national fitness program which consisted of two levels, one for general participation and one for an outstanding fitness level for their age, about 15% of students received the higher level. There were essay contests and poster contests conducted by the school division for each grade on the history of Canada and the significance of the Canadian Centennial.

All students in Canada received a Canadian Centennial Medallion; every classroom at Neil Campbell received a set of Canadian encyclopedias; in 1967 there was still no library at Neil Campbell, each classroom held a number of books appropriate for the grade.

As a Centennial project the City of East Kildonan developed the park behind Neil Campbell as a picnic and recreational area. The park was originally to be called Neil Campbell Park but it was changed to Centennial Park in late 1967 and it was completed and officially opened in 1968. The park contained the same amenities as today but there were some things that have not survived due to vandalism over the years. In 1968 there were many more picnic tables with each picnic table having a cold water tap and barbeque grill beside it. There was also a large metal slide, swings and monkey bars in the park. The first playground equipment built on the Neil Campbell School grounds did not come into existence until the 1980's. The park also contained a large wooden gazebo which after several acts of arson was torn down and not replaced.

School in this era began at 9:00 and lunch was from 11:55 to 1:25 and school ended at 3:55. All students went home for lunch as everyone lived in the immediate area and except for rare occasions there were no provisions made for students to have lunch at the school. There were two recess periods in the morning and afternoon. The grades 1 -3 had the first recess and the grades 4-6 had the second recess which began immediately after the first. Students only did not go outside for recess in the colder months as students were expected to go outside regardless of the temperature. For raining days students were kept indoors and when the playgrounds were muddy after rains and during the spring melt students were restricted to the outside paved areas.

Opening ceremonies each morning were begun by the playing of "O Canada" on a record player that was placed in the hall in the center of the school. All classroom doors had to be kept open for the music to be heard in all classrooms as there was no PA system in the school. As the same record was played each day after a while clicks, pops and sometimes the skipping of the record could be heard. After "O Canada" was played the classroom door was shut and the "Lord's Prayer" was recited in each classroom and in the lower grades this was followed by a short reading from the Bible. At the end of the day the record player was brought back into the hall where "God Save The Queen" was played.

A long time annual event was the spring tea where parents, other family members and members of the community shared a cup of tea and were entertained by the grade four students under the supervision of long time grade four teacher Mr. Steel. The grade four students put on a short play dealing with the theme of the event such as in 1967, Canada's Centennial or in 1970, Manitoba's Centennial.

Some activities that have long ago disappeared are the morning school broadcasts that CBC television carried on weekday mornings designed for different grades and watched by Neil Campbell students in the gym or in the multipurpose room on school black and white television sets. There were also special school radio broadcasts on CBC radio listened to by students in their classrooms as each classroom contained a radio that had to be placed by the window in order for the station to be heard. Programs like "Tuneful Tales" that Neil Campbell students often appeared on and programs such as on art where

students followed the instructions of the announcer in painting or constructing some art project.

In the summer of 1968 work was started on Neil Campbell's second and last addition on the south side of the building. This \$205,000 project was built in anticipation of kindergarten starting in the school and throughout the school division in September 1969. Prior to 1969 kindergarten programs were private affairs and held in churches in the area. The United Church at Kimberly and Golspie and the Baptist Church at Oakview and Watt were attended by many children who went onto grade one at Neil Campbell.

The 1968-1969 added a kindergarten area and grade one classrooms were moved to the new area. The school office area was converted to a hallway leading to the library, then known as the Material Resource Centre and to the music room/multipurpose room. A new office was constructed out of what had been previously a classroom in the original section of the school.

Construction was completed early in 1969 and this completion resulted in some classes of students and teachers moving their desks and all of their supplies to new classrooms. The grade one students moved into the new area, with the grade two classes moving into what had been the grade one classrooms and the grade three students moving into what had been the grade two classrooms midway through the school year. All of the books that had been previously kept in the classrooms were moved to the new Material Resource Centre creating a central library collection. The creation of the library brought volunteers working in the school on a regular basis for the first time ever as mothers of students helped staff it.

The beginning of kindergarten in September 1969 brought the first busing of students to Neil Campbell as kindergarten students were bused in from the New Rosewell School area where there were no facilities for kindergarten. New Rosewell School has long since closed but it is now the location of the school division's maintenance offices at Molson and McLeod.

The late 1960's and early 1970's were the peak period for student enrolment at Neil Campbell. During the entire period of the 1960's the enrolment was well above 500 students each year and during the peak year 1970-1971 there were 659 students in the school for at least half the day. As the 1970's moved on the total enrolment began to decline each year, where once that had been three or sometimes four classes per grade, two classrooms per grade became the new norm.

Beginning in 1971 was an annual trip taken first by grade six students, in later years grade five students were added to this June trip to Nutimik Lake in the Whiteshell where they experienced some outdoor education

In the 1973-1974 school year an option program was introduced for grade two to six students. Children were given the option of taking one of the following; embroidery, knitting, macramé, sewing, carpentry, gymnastics, chess, outdoor education, model

building, puppetry, music, school newspaper, cooking, drawing, painting and sketching, sculpture film making and crafts.

By the middle of the 1970's some students living in the area of the River East School Division including some in the Neil Campbell School catchment were attending French Immersion programs in the St. Boniface School Division. Parents in this period were pushing to have students bused from the area to St. Boniface as it was felt that a French Immersion program was not likely to be started in the River East area in the future. As the years of the 1970's passed the demand for French Immersion in the local area increased which would have ramifications for Neil Campbell in the 1980's.

In 1976 Neil Campbell began the tradition of holding a "Fun Fair" in May of the year. The event consisted of a series of games along with the sale of home baking, a white elephant sale, books, hamburgers, chips and drinks. There was also a coffee room set aside for the adults.

Neil Campbell students in March 1978 received an unexpected two day holiday when a watermain broke flooding the basement of Neil Campbell to a depth of 4 meters and flooding some classrooms to a depth of 30 cm. It was estimated that some 900,000 litres of water flooded the school. The school's electrical and heating system was knocked out and the resulting clean-up and damage costs were estimated at \$10,000.00. The Winnipeg Fire Department was given the job of pumping out all that water from the school.

In 1978 Neil Campbell School was listed as one of the eleven kindergarten to grade six schools in the division that were below 80% in capacity and were continuing to decline in their enrollment. Neil Campbell School in the 1978-1979 school year had 339 pupils down from the 659 pupils at its peak in the 1970-1971 school year. In 1979-1980 it was to dip further to 326 students.

In early 1979 a delegation of local parents representing Canadian Parents for French approached the River East School Board about starting a French Immersion program in the division beginning at the kindergarten level. At the time 42 children from the division attended French Immersion at schools in St. Boniface and Transcona. The decision of the board was to conduct a survey of the demand for French Immersion and the cost of the new program. In June 1979 the school board announced that a French Immersion as well as an Ukrainian Immersion program would start in September 1979 but by July 1979 these plans were cancelled as insufficient students had registered for the two programs. In the case of the French Immersion program only sixteen students had registered when a minimum of twenty-five students was required to begin the program.

To honour the year 1979 which was declared the year of the child, Neil Campbell School dedicated their annual "Fun Fair" to the theme of the child by holding games and food displays representing many nations.

In March 1980, Neil Campbell School was designated as the French Immersion school in the River East School Division with French Immersion to begin at the Kindergarten and

grade level in September as long as sufficient students were registered for the program. In May 1980 the decision was made only to offer French Immersion for kindergarten only at Neil Campbell in September because only ten students had been registered for grade one which was deemed insufficient. A decision was also made that there would be no busing of kindergarten students to Neil Campbell and parents were advised that they would be responsible for finding transportation for their children if they lived too far away from the school for their children to walk.

In September 1981 grade one was added to the French Immersion program at Neil Campbell and each year another grade was added until French Immersion was available for all grades; this was accomplished in September 1986. In September 1982 French Immersion was begun at Springfield Heights School and a late French Immersion program was begun at Lord Wolseley School because of the growing demand for the program.

By 1987 the French Immersion program was so successful that there were almost four French Immersion students to every student in the English Language program which raised concerns among some parents in the English language program that their children's program were in danger at Neil Campbell. As of the 1986-1987 school year grade two and three students in the English program were together in one classroom and it was proposed that for September 1987 that grades one and two would be combined in one classroom with the grade three and four students combined in another classroom. Some parents said that in the past that some of the slow learners had suffered when they had been in a combined class. It was pointed out that some students in the English language program living in the immediate vicinity of Neil Campbell had been enrolled in other schools because of the existing combined class at Neil Campbell and more students were certain to follow if the existing English program was degraded further. In the end the decision was made to look at changing the catchment area for the French Immersion program and promises were made not to further combine more grades in the English program after the second classroom was combined.

The end of the 1980's brought changes to Neil Campbell as Principal Charlie Douglas left Neil Campbell in June 1988 to become the principal of Miles MacDonell Collegiate where he left in 1959 to come to Neil Campbell. Jeff Carter replaced him as principal. As well technological change occurred as Neil Campbell obtained its first computer, the first one was obtained for the office at the end of the 1980's.

In February 1989 the decision was made to change the boundaries for the French Immersion catchment area beginning in September 1989. The boundary was shifted to the north of Concordia with those living south transferred to Salisbury School. This decision reduced the number of French Immersion students by 60 students. The change meant that there would now be two classes of Immersion students for each grade instead of three classes for each grade as previously existed. There was some concern by some parents of those students who were to be moved to Salisbury School that Neil Campbell was a better school but in the end the decision held.

In June 1991, the school board expressed its concern with the drop in the number of students that had been registered for kindergarten for September 1991 as only 105 students were registered as compared to 167 students registered for the previous year with a good number of the drop off occurring at Neil Campbell. One of the proposals that was suggested was to move all French Immersion students living north of the Perimeter Highway to Neil Campbell.

The early 1990's were a period of tight budgeting and restraint at all levels of government which affected all schools including Neil Campbell but still in this period Neil Campbell received its first computers for the specific use of students.

In the fall of 1994 it was announced that user fees for the supervision of children staying for lunch at school would be instituted for many schools in the division as a result of new collective agreement with the River East Teacher's Association which exempted teachers from this duty as they were given a 55 minute uninterrupted lunch hour.

In the fall of 1995 newly appointed principal of Neil Campbell Glen Brooks and the staff and parents of Neil Campbell was forced to review the school's personal safety rules when a dangerous convicted sex offender moved near the school. There were no incidents reported involving Neil Campbell students but the school community was on edge throughout the year.

The Herald newspaper reported in July 1996 on Gerry Dorge's grade five and six students who take to the air in hang gliders from the hill near Kildonan East Collegiate. The experience was the 5th year that the Neil Campbell teacher had taken his students on as a reward for good behavior throughout the school year.

November 7, 1996 was an important day in Neil Campbell's history as it was the day the school celebrated its 40th anniversary with an open house. Former students and staff were invited back to see old photographs, watch a fashion show and remember the good old days with friends. The school celebrations in the evening were attended by almost 700 persons.

Neil Campbell School in the years since 1996 has continued to educate and contribute to the community but like many schools in the older communities there has been a slow decline in the student enrollment numbers but despite this the future continues to be bright for the community and for Neil Campbell School.

Student Enrollment By School Year

1956-1957 – 246
1957-1958 – 274
1958-1959 - 243
1959-1960 – 528
1960-1961 – 494
1961-1962 – 579

1962-1963 – 586
1963-1964 – 536
1964-1965 – 572
1965-1966 – 545
1966-1967 – 557
1967-1968 – 572
1968-1969 – 566
1969-1970 – 657
1970-1971 – 659
1971-1972 – 595
1972-1973 – 549
1973-1974 – 525
1974-1975 – 506
1975-1976 – 492
1976-1977 – 467
1977-1978 – 382
1978-1979 - 370
1979-1980 – 344
1980-1981 – 339
1981-1982 – 413
1982-1983 – 380
1983-1984 – 411
1984-1985 – 468
1985-1986 – 380
1986-1987 - 489
1987-1988 – 527
1988-1989 – 507
1989-1990 – 402
1990-1991 – 403
1991-1992 – 392
1992-1993 - 356
1993-1994 – 365
1994-1995 - 362
1995-1996 – 354
1996-1997 – 384
1997-1998 – 357
1998-1999 – 391
1999-2000 – 386
2000-2001 – 372
2001-2002 – 356
2002-2003 – 338
2003-2004 – 351
2004-2005 – 353
2005-2006 – 339
2006-2007 - 321

Neil Campbell School Winners in the Winnipeg Music Festival

Annie Pullar Trophy: Most outstanding performance by a classroom choir, kindergarten to grade 3

1979

1980

1984

Lola MacQuarrie Memorial Trophy: Most outstanding performance of a folksong by a school choir, kindergarten to grade 6

1981

Mozart Shield: Most outstanding performance by a school classroom choir for action songs and singing games, kindergarten to grade 6

1984

Peter Logan Memorial Trophy: Most outstanding performance by a school classroom choir, grades 4 to 6

1981

Sir Hugh S. Robertson Trophy: Most outstanding performance by a school choir, kindergarten to grade 6

1965

1974

Winnifred Tufts Memorial Trophy

1965

1974